



Restore. Regrow. Renew.

OSSIOfiber® Compression Staple

Surgical Technique



1 Sizing

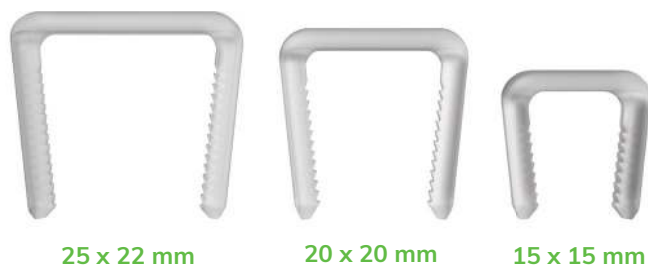

- After performing the appropriate osteotomy, or preparing the fusion site, use a surgical ruler to determine the appropriate size staple. Take care to ensure that both endpoints of the measurement provide adequate bone stock for staple fixation. Aim to maintain a minimum of 5mm between staple legs and fusion, fracture, or osteotomy site.

2 Bone Preparation

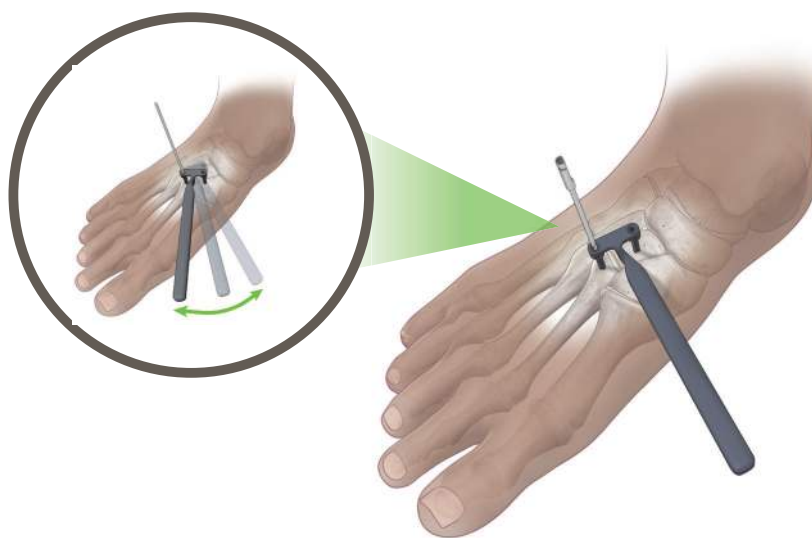

- Position drill guide across the site and ensure the drill guide rests flush on the bone.
- Using the provided 2.5 mm drill bit, drill until the laser mark on the drill bit meets the opening on the drill guide.
- To maintain the position of the drill guide, insert a locating pin within the previously prepared drill hole.

Tip: The first locating pin can be used as a pivot point to position the second drill hole final location.

Bone Preparation (cont'd)

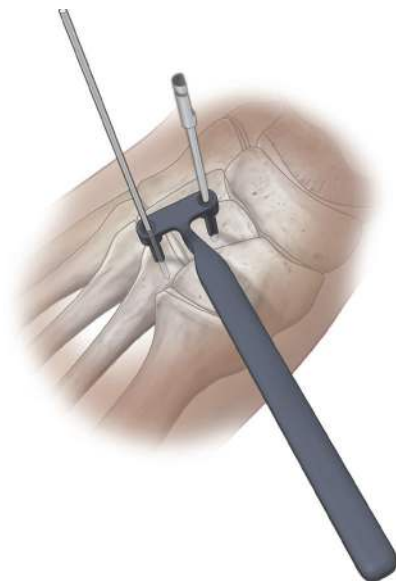

- With the appropriate second hole position selected, drill the hole using the technique stated previously.

Tip: To maintain visualization of hole location, leave the locating pins in place until staple insertion.

3 Staple Insertion

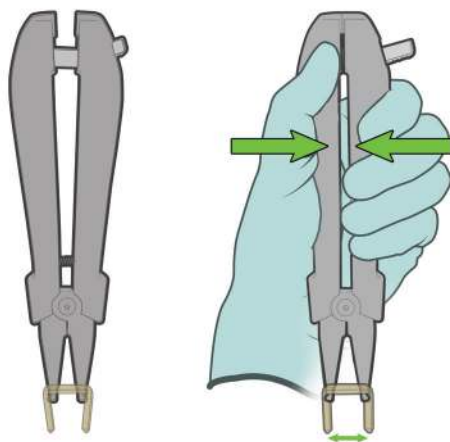

- Load the staple on the provided inserter by resting the bridge flush against the inserter legs.
- Squeeze the inserter handle until an audible click is heard and the staple legs are parallel. Once engaged, the inserter will maintain the open position of the staple until released.

Note: A slight change in material color at the bend of the staple when engaging the inserter is normal and does not affect performance.

Staple Insertion (cont'd)

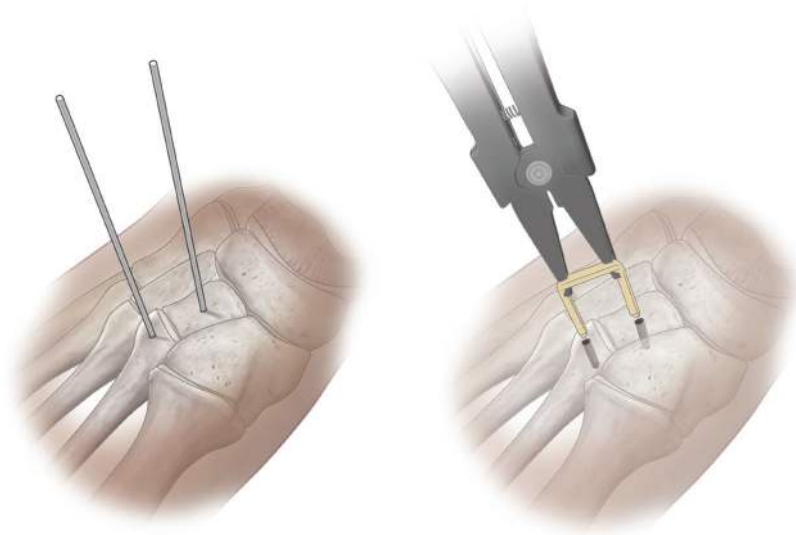

- Align the staple to the locating pins trajectory and remove the locating pins, replacing their position with the implant.

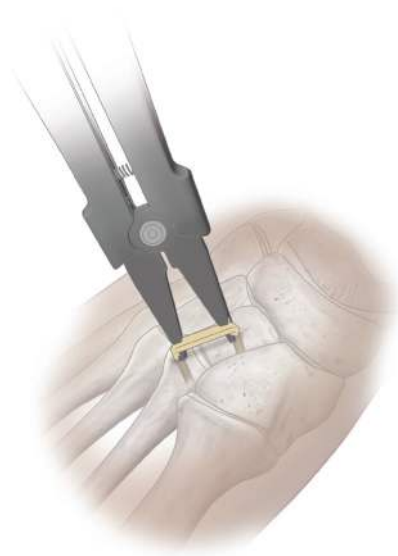
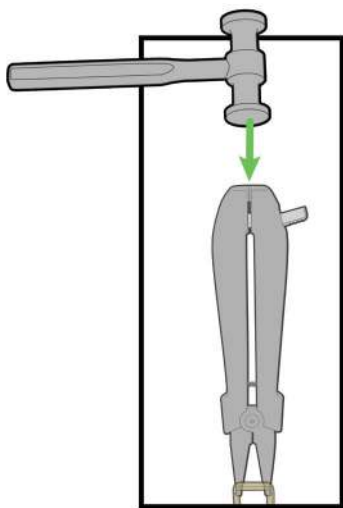

- Insert the staple into the prepared drill holes. Prior to impaction, ensure that the inserter lever is completely down in a full locked position. Use a surgical mallet on the end of the inserter handle for impaction.

Staple Insertion (cont'd)

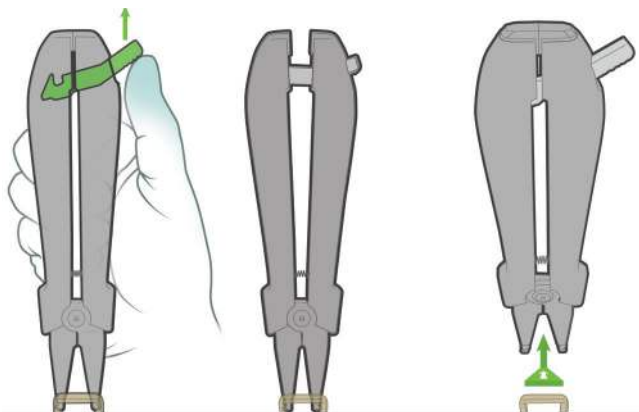

- Once insertion of the staple is attained, release the tension on the inserter legs by slightly squeezing the handles and pushing the lever away from the implant.
Remove the inserter by tilting the legs away from the implant. The staple legs will compress once the inserter is removed.

4 Implant Seating

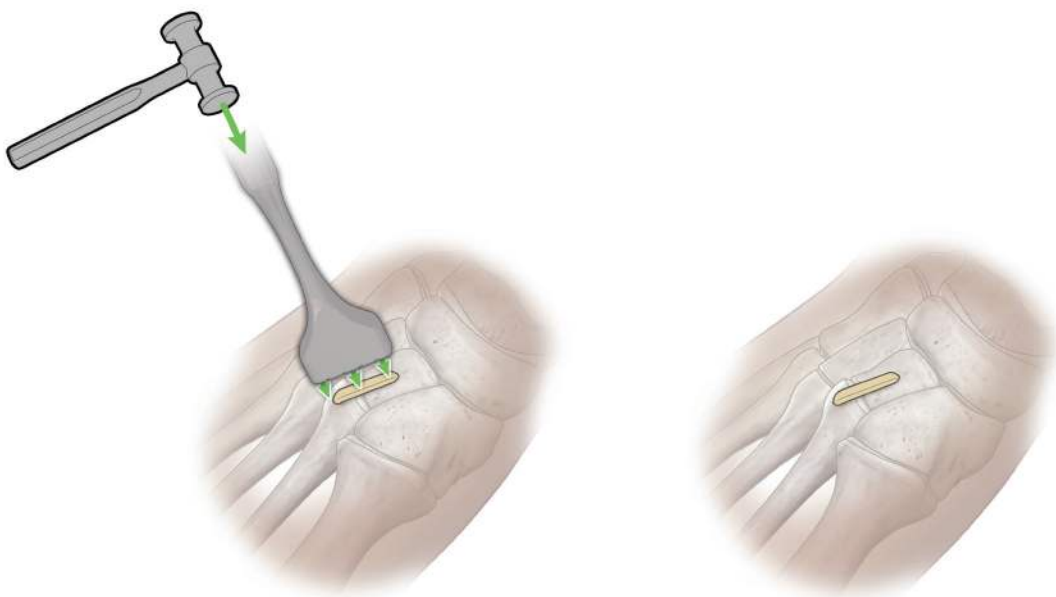

- Place the end of the tamp flush to the bridge of the staple covering the entire width of the implant.
- Using a surgical mallet, tamp the staple until fully seated.
- Once the implant is flush to the bone, do not impact forcefully.

OSSIOfiber® Compression Staple Ordering Information

Staple Systems

(Each System includes one implant and one instrument kit)

Description	Product Code
OSSIOfiber® Compression Staple System, 15 x 15 mm	OF2061515S
OSSIOfiber® Compression Staple System, 20 x 20 mm	OF2062020S
OSSIOfiber® Compression Staple System, 25 x 22 mm	OF2062522S

Standalone Staples

Description	Product Code
OSSIOfiber® Compression Staple, 15 x 15 mm	OF1061515S
OSSIOfiber® Compression Staple, 20 x 20 mm	OF1062020S
OSSIOfiber® Compression Staple, 25 x 22 mm	OF1062522S

Sterile, Disposable Instrumentation

Sterile, Disposable Instrumentation System

Streamline OR preparation and reduce unnecessary exposure to pathogens with the use of sterile, disposable instrumentation.

- 1.4mm K-wire x 2
- Drill Bit
- Locating Pins x 2
- Drill Guide
- Inserter
- Tamp



Indications

The OSSIOfiber® Compression Staples are indicated for fixation of arthrodesis, osteotomies and fractures in hand or foot surgery in the presence of appropriate brace and/or immobilization. The number and size of the OSSIOfiber® Compression Staples must be adapted to the indication.

Contraindications

The OSSIOfiber® Compression Staple should not be used in situations where internal fixation is otherwise contraindicated, e.g., active or potential infection, limited blood supply, insufficient quantity or quality of bone, or where patient post-operative compliance cannot be guaranteed.

DOC-0002487 11/2022

® OSSIO® and OSSIOfiber® are trademarks of OSSIO Ltd. All rights reserved 2022.
For more on OSSIO® and OSSIOfiber®, please visit ossio.io

Refer to the product Instructions for Use for warnings, precautions, indications, contraindications, and technique.

Not available for sale outside of US. Speak to your local sales representative for product availability.

300 Tradecenter Drive, Suite 3690, Woburn, MA 01801

The logo for OSSIO, featuring the word "OSSIO" in a bold, green, sans-serif font. The letter "O" is stylized as a solid green circle. A registered trademark symbol (®) is located at the top right of the second "O".

Restore. Regrow. Renew.